

Solo and Ensemble Contest
Peoria Christian High School
3506 N. California Avenue
Peoria, Illinois

March 6, 2010

Preparation & Event Information

1. Know your time and room. Be sure to arrive at least an hour before your time to find the room, warm up and prepare. There will be lots of cancellations that day so your time might move up.
2. Be sure you have an **original** of your selection to present the judge *with the measures numbered*. Failure to do either will result in your rating being lowered.
3. If your selection is accompanied (performed with piano) it must be performed such. Make arrangements with your piano player and be sure to pay them for their time. \$25-35
4. There will be no bus from IVC. As everyone is scattered through the day it makes no sense for all to ride over in the morning and wait around all day. Have your parents bring you over. We only allow students to drive if an adult is not available.
5. Instrumental soloists have to perform scales too. Mr. D has them, see him.
6. Dress professionally. NO JEANS!! Look your best!!
7. If needed Mr. D will be in either the home room or the director's area. For the most part you are on your own, BUT if you need help find him!!!!
8. Our home room is the main gym.
9. Results will be posted somewhere on a screen during the event. Sheets will be available on Monday.

Location and Facilities:

Peoria Christian is located at 3506 N. California Ave. For those of you familiar with Peoria you would turn onto California Ave. from Hwy 150 (War Memorial) across from the District 150 football/athletic field.

Parking:

Bus parking is in the front lot off of California Ave. All other vehicles please park in the back lot. Do not park on the side lot because it is being used for another school event that day.

Percussion:

Peoria Christian will provide four timpani, chimes, xylophone, bells, and vibraphone. All other percussion will need to be provided by each school; for larger equipment please note the percussion load-in door marked on the attached floor plan. Peoria Christian can arrange to move your larger items in and out when your events are scheduled.

Student warm-up and storage area:

This area is in the main gym conveniently located by the main entrance off of the front parking lot. An entrance is located off of the back parking lot and is marked on the attached floor plan as well.

Concessions:

Peoria Christian will offer concessions in the multipurpose room and kitchen area. They will serve breakfast and lunch items. Snacks are also available for purchase throughout the day.

War Memorial (HWY 150)

Side Parking Lot Reserved
(Please Do Not Park Here)

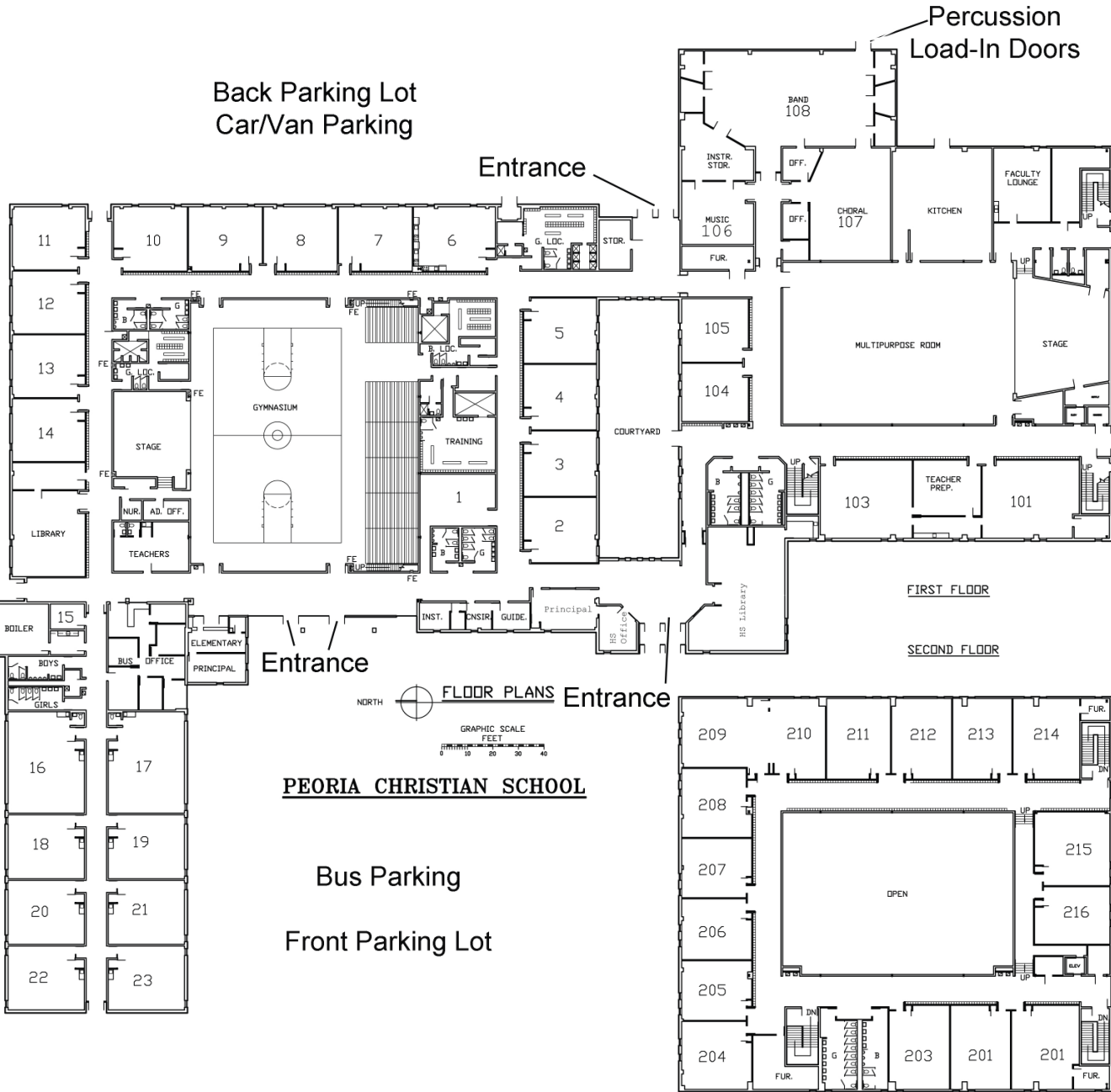

Back Parking Lot
Car/Van Parking

Entrance

Percussion
Load-In Doors

- Concessions - Kitchen Multipurpose Room
- Judge's Break Room
Choir Room
- Director's Lounge
Elementary Teachers
- Student Warm Up and Storage Area in gymnasium

Entrance

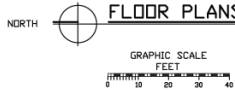

PEORIA CHRISTIAN SCHOOL

Bus Parking

Front Parking Lot

California Ave.

IHSA State Solo and Ensemble Contest at Peoria Christian High School, Peoria, IL on March, 6, 2010

School: Illinois Valley Central HS - 0331 - 48 Events Entered

| Rating | Entry | Time | Serial # | Event | Name | Size | Judge | Room | Accompanist |
|--------|-------|----------|-------------|-----------------------------------|---------------------|------|----------------------|------------|---------------|
| | 1 | 8:30 AM | EVT00000035 | 207 B-Flat Clarinet | Rebekah Durig | 1 | Griggs, Joyce | 3 | Mrs. Durig |
| | 2 | 8:40 AM | EVT00000033 | 205 Bassoon | Cassidy Losey | 1 | White, Judy | 10 | Mrs Brown |
| | 3 | 8:50 AM | EVT00000047 | 219 Tuba | Austin Wilhelm | 1 | Wanack, Ted | 13 | Mrs. Mitchell |
| | 5 | 9:10 AM | EVT00000044 | 216 French Horn | Tyler Sutton | 1 | Parish, Tracy | 11 | Mrs. White |
| | 6 | 9:15 AM | EVT00000060 | 240 Female Voice | Taylor Didesch | 1 | Redlingshafer, Toni | 214 | Dorough |
| | 6 | 9:15 AM | EVT00000060 | 240 Female Voice | Kaitlyn Farris | 1 | Walker, Cherilee | 203 | dorough |
| | 7 | 9:24 AM | EVT00000060 | 240 Female Voice | Tinia Martin | 1 | White, Kristin | 215 | Dorough |
| | 7 | 9:24 AM | EVT00000060 | 240 Female Voice | Dani Jones | 1 | Redlingshafer, Toni | 214 | Dorough |
| | 7 | 9:24 AM | EVT00000061 | 241 Male Voice | Reid Greer | 1 | Graham, Justin | 206 | Dorough |
| | 8 | 9:33 AM | EVT00000060 | 240 Female Voice | Schultz Allison | 1 | Redlingshafer, Toni | 214 | Harms |
| | 8 | 9:33 AM | EVT00000060 | 240 Female Voice | Kara Shatto | 1 | White, Kristin | 215 | Dorough |
| | 8 | 9:40 AM | EVT00000035 | 207 B-Flat Clarinet | Michael German | 1 | Diepenbrock, Sherril | 6 | Mrs Mitchell |
| | 10 | 9:51 AM | EVT00000060 | 240 Female Voice | Kendra Davis-Walker | 1 | Wanack, Jan | 212 | Dorough |
| | 10 | 9:51 AM | EVT00000061 | 241 Male Voice | Braden Griffis | 1 | Graham, Justin | 206 | Dorough |
| | 11 | 10:00 AM | EVT00000060 | 240 Female Voice | Morgan Beal | 1 | Walker, Cherilee | 203 | Harms |
| | 11 | 10:00 AM | EVT00000060 | 240 Female Voice | Lindsey Pugh | 1 | Wanack, Jan | 212 | Dorough |
| | 12 | 10:09 AM | EVT00000060 | 240 Female Voice | Haley Jones | 1 | Montgomery, Nicole | 208 | Harms |
| | 12 | 10:09 AM | EVT00000060 | 240 Female Voice | Storm Audra | 1 | Wanack, Jan | 212 | Dorough |
| | 12 | 10:09 AM | EVT00000060 | 240 Female Voice | Michelle O'brien | 1 | Meyer, Rebecca | 210 | Dorough |
| | 13 | 10:18 AM | EVT00000060 | 240 Female Voice | Lawson Delaney | 1 | Montgomery, Nicole | 208 | Harms |
| | 13 | 10:30 AM | EVT00000043 | 215 Trumpet, Cornet or Flugelhorn | Josh Rose | 1 | Parish, Tracy | 11 | Mrs Mitchell |
| | 14 | 10:27 AM | EVT00000060 | 240 Female Voice | Leah Brincks | 1 | Montgomery, Nicole | 208 | Dorough |
| | 14 | 10:40 AM | EVT00000053 | 229 Piano | Meri Terpstra | 1 | Orfe, John | HS Library | A cappella |
| | 16 | 10:45 AM | EVT00000060 | 240 Female Voice | Sarah Bollinger | 1 | Wanack, Jan | 212 | Harms |
| | 17 | 10:54 AM | EVT00000061 | 241 Male Voice | Alex Bryant | 1 | Moser, Kirk | 204 | Dorough |
| | 17 | 10:54 AM | EVT00000060 | 240 Female Voice | Elizabeth Wilford | 1 | Walker, Cherilee | 203 | harms |
| | 17 | 10:54 AM | EVT00000060 | 240 Female Voice | Ashley Larson | 1 | Montgomery, Nicole | 208 | Harms |
| | 18 | 11:03 AM | EVT00000061 | 241 Male Voice | Dusty Bredeman | 1 | Moser, Kirk | 204 | Harms |
| | 19 | 11:12 AM | EVT00000060 | 240 Female Voice | Madison Auge | 1 | Walker, Cherilee | 203 | Harms |
| | 19 | 11:30 AM | EVT00000041 | 213 B-Flat Tenor Sax. | Brittany Fritz | 1 | Griggs, Joyce | 3 | Mrs White |
| | 19 | 11:30 AM | EVT00000030 | 202 Flute | Briannne Daly | 1 | White, Judy | 10 | Mrs. Mitchell |

| Rating | Entry | Time | Serial # | Event | Name | Size | Judge | Room | Accompanist |
|--------|-------|---------|-------------|---------------------------------|-----------------|------|----------------------|------------|---------------|
| | 22 | 1:00 PM | EVT00000030 | 202 Flute | Rachael Smith | 1 | Diepenbrock, Sherril | 6 | Mrs White |
| | 23 | 1:10 PM | EVT00000045 | 217 Trombone | Jim Mitchell | 1 | Wanack, Ted | 13 | Mrs. Mitchell |
| | 24 | 1:20 PM | EVT00000004 | 4 Saxophone Ensemble | Fritz, et al | 2 | Diepenbrock, Sherril | 6 | A Cappella |
| | 24 | 1:20 PM | EVT00000019 | 19 Keyboard Percussion Ensemble | Terpstra, et al | 2 | Jerauld, Eric | Band Room | a cappella |
| | 25 | 1:06 PM | EVT00000026 | 152 Mixed Ensemble | Hartman, et al | 2 | Graham, Justin | 206 | Harms |
| | 25 | 1:30 PM | EVT00000004 | 4 Saxophone Ensemble | Gardiner, et al | 2 | Diepenbrock, Sherril | 6 | A cappella |
| | 26 | 1:15 PM | EVT00000061 | 241 Male Voice | Chris Coffey | 1 | Moser, Kirk | 204 | Harms |
| | 27 | 1:24 PM | EVT00000024 | 150 Treble Ensemble | Keffeler, et al | 2 | Redlingshafer, Toni | 214 | Harms |
| | 30 | 2:20 PM | EVT00000053 | 229 Piano | DNA Davis | 1 | Orfe, John | HS Library | a cappella |
| | 30 | 2:20 PM | EVT00000014 | 14 Tuba/Euphonium Ensemble | Mitchell, et al | 4 | Wanack, Ted | 13 | a cappella |
| | 32 | 2:09 PM | EVT00000024 | 150 Treble Ensemble | Bredeman, et al | 6 | Redlingshafer, Toni | 214 | Dorough |
| | 34 | 3:00 PM | EVT00000004 | 4 Saxophone Ensemble | Judy, et al | 2 | Griggs, Joyce | 3 | A cappella |
| | 37 | 3:30 PM | EVT00000001 | 1 Flute Ensemble | Terpstra, et al | 2 | White, Judy | 10 | a cappella |
| | 38 | 2:54 PM | EVT00000024 | 150 Treble Ensemble | Donnelly, et al | 2 | Redlingshafer, Toni | 214 | Harms |
| | 38 | 3:03 PM | EVT00000026 | 152 Mixed Ensemble | Machlin, et al | 2 | Graham, Justin | 206 | Dorough |
| | 42 | 3:39 PM | EVT00000024 | 150 Treble Ensemble | Wilford, et al | 2 | Meyer, Rebecca | 210 | Dorough |
| | 43 | 3:48 PM | EVT00000026 | 152 Mixed Ensemble | Bryant, et al | 6 | Wanack, Jan | 212 | Dorough |